



LINCOLN

## 5-IN-1 HAND-HELD KNIFE & SCISSORS SHARPENER LINHHKS

Adjustable 5-in-1 to meet different sharpening needs. Customised super hard carbide for quick sharpening. A soft rubber knob makes it more comfortable to hold. Ideal for use with various knives, scissors and tools. Unique resin diamonds make it more durable.

### USING INSTRUCTIONS

1. Place the knife sharpener on a stable surface when using.
2. Following the instruction on the sharpener, turn the knob to the right sharpening slot.

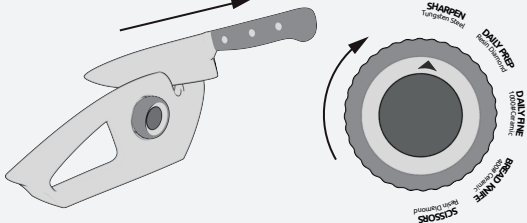

### FOR KNIVES

Select "SHARPEN" for coarse sharpening, "DAILY PREP" for medium sharpening, and "DAILY FINE" for polishing.

**Step 1:** "SHARPEN" - Coarse sharpening for a blunt knife. Place the knife into the sharpening slot, keep the knife in the middle of the slot and pull it along the blade, from the base to the tip, **gently**.

**Step 2:** "DAILY PREP" - Medium sharpening for daily maintenance. Please refer to step 1 for sharpening method.

**Step 3:** "DAILY FINE" - Necessary step to remove burrs on the knife after sharpening. Please refer to step 1 for sharpening method. It is recommended to sharpen approximately every two weeks to keep the knife sharp.

### FOR BREAD KNIVES

Bread knives are available in right-hand and left-hand versions. Please confirm your bread knife is right-hand or left-hand versions before sharpening.

Right-hand version - Serrations are located on the right side of the bread knife.

**Step 1:** Select "BREAD KNIFE" slot. Hold the knife sharpener with your left hand and hold the bread knife with your right hand.

**Step 2:** Put the knife into the sharpening slot, pull the knife back slightly from the base to the tip until the blade is sharp.

DO NOT move the blade backwards and forwards.  
Pull in ONE DIRECTION only.

Left-hand version - Serrations are located on the left side of the bread knife.

**Step 1:** Select "BREAD KNIFE" slot. Hold the knife sharpener with your right hand and hold the bread knife with your left hand.

**Step 2:** Put the knife into the sharpening slot, pull the knife back slightly from the base to the tip until the blade is sharp.

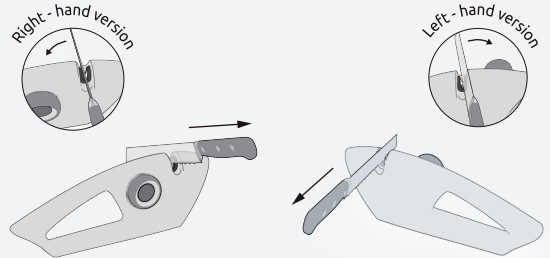

### FOR SCISSORS

Select "SCISSORS" slot and open the scissors. Place the scissor blade on the middle of the sharpening slot. Then put the scissor blade inclining towards the long bevel of ceramic. Pull it back until the blade is sharp.

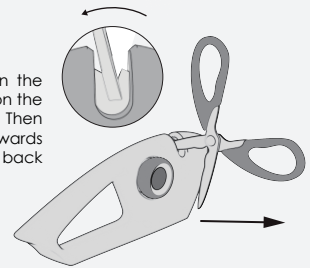

### CAUTIONS

Handle knife with care when sharpening to prevent damage. Avoid dishwasher or water immersion of the sharpener. Keep the knife sharpener and knives out of children's reach to prevent accidents.

### SPECIFICATIONS

Brand	Lincoln
Model	LINHHKS
Materials	ABS, Stainless Steels, Tungsten Steel, Resin Diamond, Ceramic
Size	257mmX96mmX53mm
Weight	320g

LINCOLN



Suitable for both left-handed and right-handed users.